

# KEY FACTS & FIGURES



Experienced  
Conference  
Crew



Natural  
Daylight



FREE  
Wifi



Audio Visual  
Essentials



Unlimited Hot  
Beverages &  
Refreshments



Restaurant,  
Bar & Breakout  
Lounges



Accessible  
Facilities



Meeting Room  
Essentials

## MEETING ROOM QUICK STATS



...theatre layout



...cabaret layout



...boardroom layout

Conference Hotel	Length (m)	Width (m)	Area (m <sup>2</sup> )	Height (m)	Max Capacity Theatre	Max Capacity Cabaret	Max Capacity Boardroom
CONFERENCE 1	11.4	19.5	222	2.7	222	120	-
CONFERENCE 1A	11.4	8.3	94	2.7	94	54	46
CONFERENCE 1B/C	11.4	10.3	117	2.7	108	54	42
MEETING 123	9.2	9.2	85	2.5	70	36	36
MEETING 145	9.2	10.8	99	2.5	84	54	40

Meeting Suites	Length (m)	Width (m)	Area (m <sup>2</sup> )	Height (m)	Max Capacity Theatre	Max Capacity Cabaret	Max Capacity Boardroom
STEELHOUSE 1	8.2	7.4	61	2.95	61	45	32
STEELHOUSE 2	8.8	9.0	79	2.95	78	54	40
STEELHOUSE 3	8.6	7.0	60	2.95	60	45	28
STEELHOUSE 1-3	8.6	23.5	201	2.95	201	120	72
STEELHOUSE/ STAFFORD COMBINED	8.6	32.1	274	2.95	274	153	76
STAFFORD 1	8.5	8.6	73	2.95	73	54	32
STAFFORD 2	7.8	8.0	62	2.95	62	45	28
STAFFORD 1-2	17.5	7.7	135	2.95	135	90	60
WHITE HALL 1	7.6	7.5	57	2.95	57	36	28
WHITE HALL 2	7.6	7.7	58	2.95	58	36	28
WHITE HALL 3	7.6	8.0	61	2.95	61	36	28
WHITE HALL 1-3	7.0	23.3	162	2.95	162	120	72

From cabaret to get the discussion flowing, or theatre style for focused presentations, we tailor our spaces for you... your space to meet, to host, in any event. You'll find a selection of breakout and syndicate rooms within a few footsteps of each of the conference suites listed above.



**YOUR EVENT SPACES.**  
ONE CAMPUS.

*The ideal rooms for my event are:*

---

---

---

**Conference Aston Meeting Suites** Ground Floor

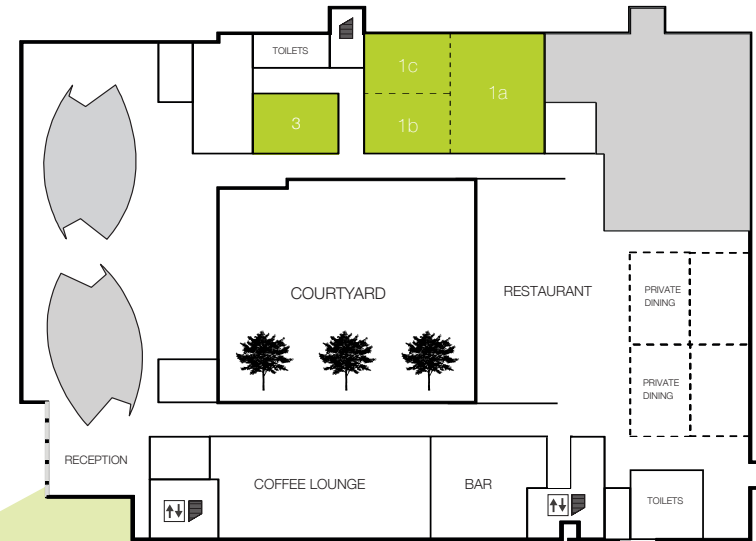
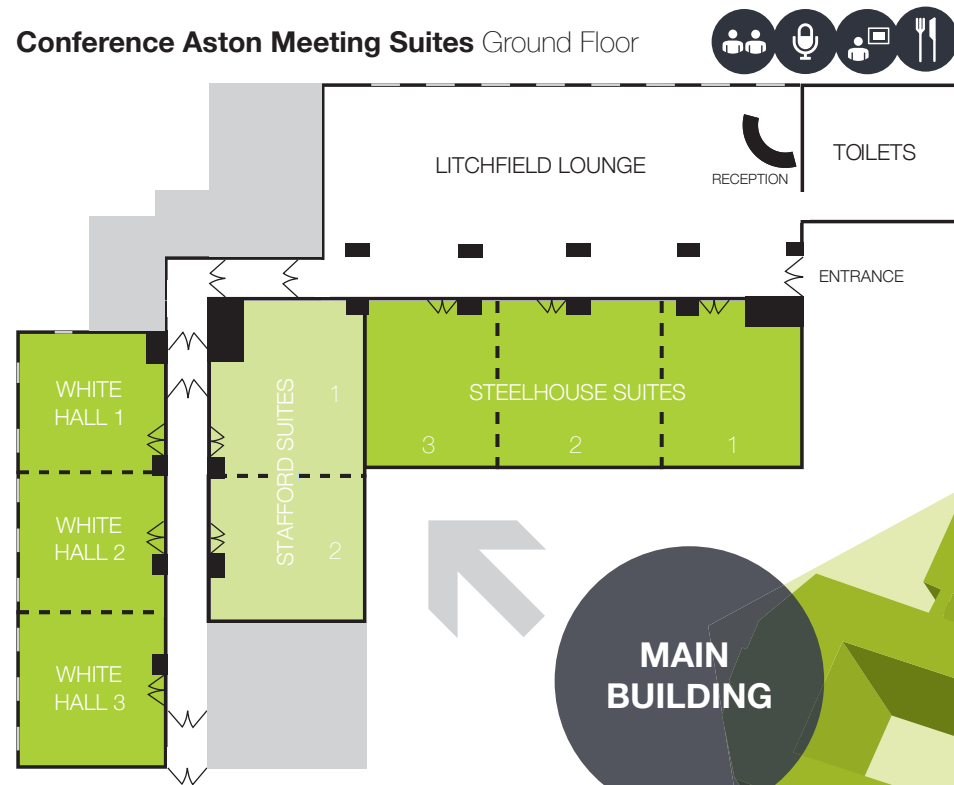

**Conference Hotel**  
Ground Floor

**MAIN BUILDING**

**CONFERENCE ASTON**



**Conference Hotel**  
First Floor

